

DATED

13th

JANUARY 2021

WILDLIFE AND COUNTRYSIDE ACT 1981

DENBIGHSHIRE COUNTY COUNCIL

**(PATH BETWEEN FFORDD TALARGOCH TO PUBLIC FOOTPATH 19
MELIDEN IN COMMUNITY OF PRESTATYN TOWN)**

DEFINITIVE MAP MODIFICATION ORDER 2021

Gary Williams

Head of Legal, HR & Democratic Services

Denbighshire County Council

County Hall

Ruthin

Denbighshire

Mae'r gorchymyn uchod wedi'i gadarnhau.
The foregoing order is hereby confirmed.

Janine Townsley

Arolygydd a benodir gan Weinidogion Cymru
An Inspector appointed by the Welsh Ministers

31 MAY 2023

WILDLIFE AND COUNTRYSIDE ACT 1981

DEFINITIVE MAP AND STATEMENT OF PUBLIC RIGHTS OF WAY FOR THE FORMER
COUNTY OF CLWYD

DENBIGHSHIRE COUNTY COUNCIL

(PATH BETWEEN FFORDD TALARGOCH TO PUBLIC FOOTPATH 19 MELIDEN IN
COMMUNITY OF PRESTATYN TOWN)

DEFINITIVE MAP MODIFICATION ORDER 2021

This Order is made by Denbighshire County Council under section 53 (2) (b) of the Wildlife and Countryside Act 1981 ("the Act") because it appears to that authority that the Definitive Map and Statement of Public Rights of Way for the former Clwyd County Council require modification in consequence of the occurrence of events specified in section 53 (3) (c) (i) of the Act, namely:

(c) the discovery of evidence which (when considered with all other relevant evidence available to them) shows:

(i) that a right of way which is not shown in the map and statement subsists or is reasonably alleged to subsist over land in the area to which the map relates.

The authority has consulted with every local authority whose area includes that land to which the Order relates. Denbighshire County Council HEREBY ORDERS that:

1. For the purposes of this order the relevant date is 13th January 2021.
2. The Definitive Map and Statement of Public Rights of Way for the former County of Clwyd shall be modified as described in Part I and Part II of the Schedule and shown on the plan attached to the Order ("the Order Plan").
3. This Order shall take effect on the date it is confirmed and may be cited as the Denbighshire County Council (PATH BETWEEN FFORDD TALARGOCH TO PUBLIC FOOTPATH 19 MELIDEN IN COMMUNITY OF PRESTATYN TOWN) Definitive Map Modification Order 2021.

THE COMMON SEAL of DENBIGHSHIRE COUNTY COUNCIL

was hereunto affixed

this 13th day of January 2021 in the presence of:

Authorised Signatory:

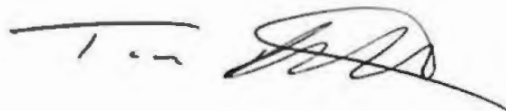

SCHEDULE

PART I

Modification of Definitive Map

Description of path to be added

A public footpath commencing from a point (marked A on the Order Plan) on the A547 Ffordd Talargoch starting at SJ 05892 80662 and running in a south easterly direction for 42.8 metres to a point at SJ 05924 80663 (marked point B on the Order Plan) and then continuing in a generally south easterly direction for 59.2 metres to a point at SJ 05965 80592 (marked C on the Order Plan) where it joins with existing public footpath 19 marked on the Order Plan.

Width: The path is approximately 3 metres wide with a mixed grass and earth surface at all points marked on the Order Plan.

Limitations: The gate at SJ 05294 80663 which is marked point B on the Order Plan.

PART II

Modification of Definitive Statement

Description of path or way to be added

A new statement shall be recorded for Footpath 55 in the Community of Prestatyn to include the following in columns (1) to (6):

- (1) 55
- (2) Public Footpath
- (3) Starting from SJ 05892 80662 on Ffordd Talargoch, A547, running in a south easterly direction for 102.1 metres
- (4) A point at SJ 05965 80592 where it joins with public footpath 19
- (5) 3 metres with a mixed grass and earth surface
- (6) 'Kissing' Gate at SJ 05294 80663



Mae'r cynllun hwn yn rhan o'r Gorchymyn Addasu Cyngor Sir Ddinbych (Prestatyn 55) 2021



This plan forms part of the Denbighshire County Council (Prestatyn 55) Modification Order 2021

Graddfa/Scale: 1: 2500

305800

306000

306200

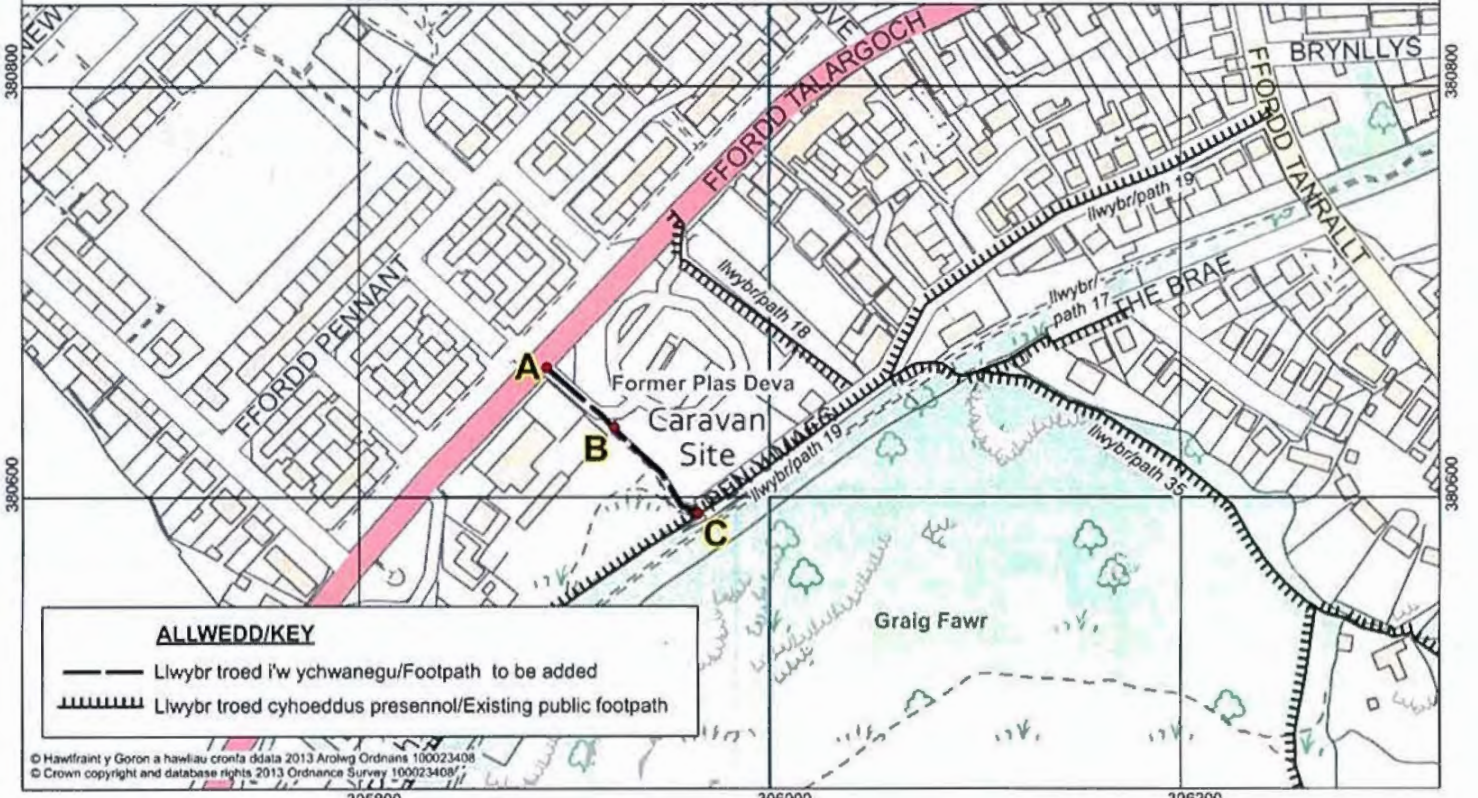

ALLWEDD/KEY

- Llwybr troed i'w ychwanegu/Footpath to be added
- - - Llwybr troed cyhoeddus presennol/Existing public footpath

© Hawfrainit y Goron a hawliau cronfa ddata 2013 Arolwg Ordnans 100023408
© Crown copyright and database rights 2013 Ordnance Survey 100023408

305800

306000

306200